



DLA16W Shower Enclosure Installation and User's guide

I. Mounting Preparation

1. After opening the case, read this introduction carefully, check all the packed parts, examine the shower cabinet for shipping damage. If the unit has been damaged or has a finishing defect, please contact your local distributor within 2 business days. Please note that DreamLine Guarantee will not cover shipping damage or such finishing defects once the unit has been installed. Your distributor's responsibility for damage in transit is limited after the shower package has been transferred to the transportation company, so you may have to contact the transportation company directly to report damage. Contact your distributor or DreamLine if you have any questions.
2. You should make sure that the floor is leveled and solid and will be able to support the total weight of the unit and its occupant. You should also consult your local building codes on questions on installation compliance standards.
3. Install all of the required plumbing and drainage before securing the shower. Use a competent and licensed (if required by local code) plumber for all plumbing installation.
4. Please insure that prior to the installation the floor is leveled and the walls are at right angles. While some adjustment in leveling of the tray is possible, irregular floor level or improper angle of side walls will result in serious problems for your installation.
5. Necessary Tools: Conventional woodworking tools, Screwdriver, Silicone sealant, Electric drill, Regular drill bits (1/8", 7/64"), Phillips screwdriver, Level, Measuring tape, Pencil and Stepladder. Bear in mind that you will need at least two people to assemble the unit.

II. Packing List

①	Narrow glass side panel	1pc	⑨	Wall fixing screw M4X30	10pcs
②	Waterproof plastic strip	1pc	⑩	Plastic dowel	10pcs
③	Entry door	1pc	⑪	Support bar	2pcs
④	Bottom waterproof strip	1pc	⑫	Corner bracket	1pc
⑤	Handles	2pcs	⑬	Movable bracket	2pcs
⑥	Wide side glass panel	1pc	⑭	Wall mount bracket	2pcs
⑦	Magnetic strip	2pcs	⑮	Fixing screw team	8pcs
⑧	Wall connecting profile	2pcs	⑯	Hinge	2pcs

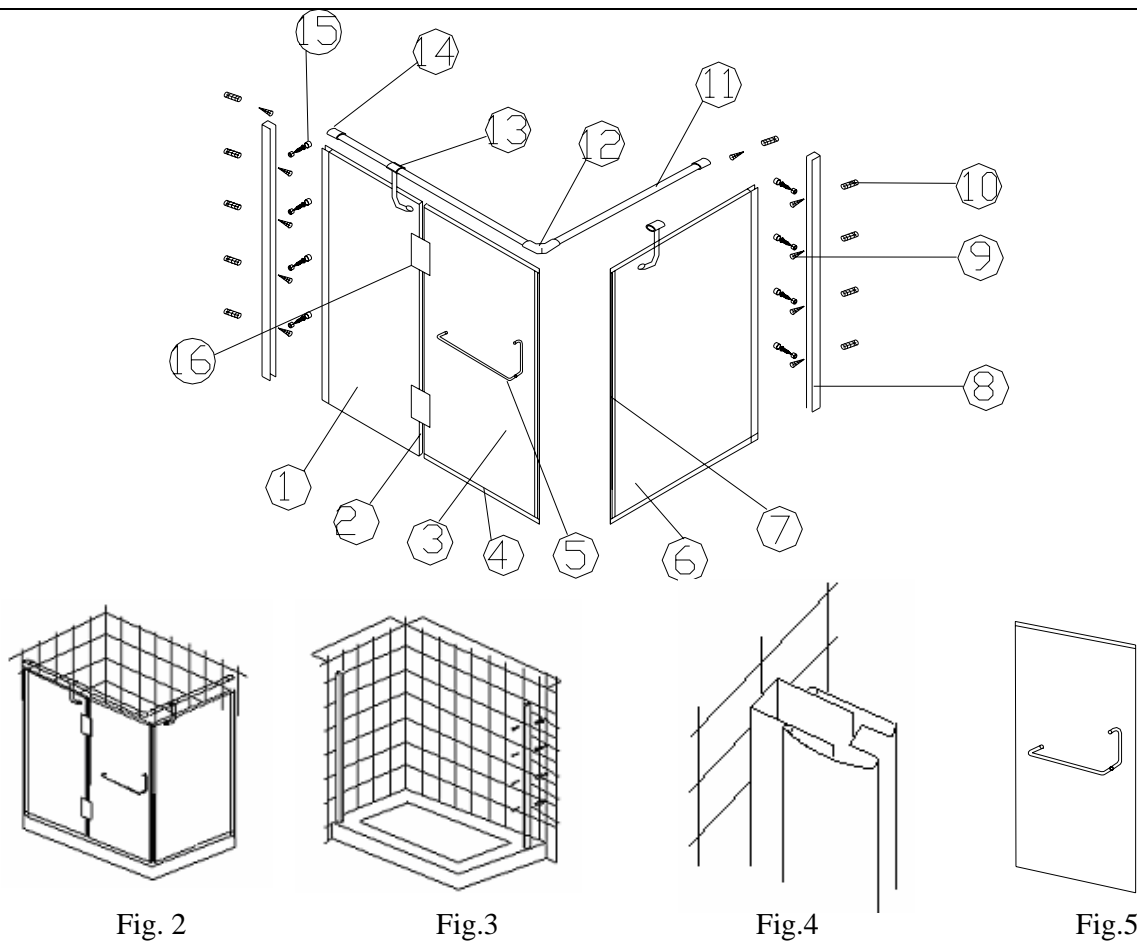

Fig. 2

Fig.3

Fig.4

Fig.5

III. Mounting Process:

It's better to assemble the glass parts of the enclosure on a soft surface to protect the glass from scratching.

1. Put the tray in the designated position and level it.
2. Place the wall connecting profiles ⑧ at proper position, make sure they are leveled to the tray and the wall and mark the holes. Drill the holes from the inner side of the wall connecting profiles with regular drill bit. Screw them tight to the wall using plastic dowels ⑩ and screws M4x30 ⑨.
3. Insert the stationary side glass panels into the wall connecting profiles.
4. Attach waterproof plastic strip to the narrow stationary side glass panel and fasten the hinge to the side glass panel making sure there are plastic gaskets on the pivots of the hinge.
5. Connect the entry door ③ to the narrow side glass panel ① with the hinge ⑬.
6. Position the support bar and mark the drill holes for wall-mount bracket.
7. Drill the holes for the wall mount brackets and fasten them tight. Secure the support bar ⑪ to the wall with the wall mount bracket, then attach corner bracket ⑫ to the support bar.
8. Repeat the same steps for the wide side glass panel ⑥ and connect the two support bars with corner bracket.
9. Attach the handles ⑤ (Fig.5) and the bottom plastic strip to the entry door.
10. Level the shower enclosure unit, making sure the door closes tight and opens smoothly. Adjust depth of side glass panel with the wall connecting profiles. Level the enclosure with the wall and the tray. (Fig.2). Fasten tight the side glass panels to the wall connecting profiles and support bar to the wall mount brackets and the corner bracket .

IV. Sealing:

Apply clear silicone water sealant around the outside perimeter of any fixed shower components (horizontally between bottom of any fixed side glass panels and tray, as well as vertically between the wall, wall profiles and any side glass panels). Do not apply silicone on the inside of the shower – this will cause your shower unit to leak.

NOTE: Allow 24 hours for the silicone to set before testing or using the shower.

NOTE: Improper application of silicone sealant may cause your shower to leak.



Installation instructions for Shower Trays with Add-on Tile Flange

1. Complete your shower framing
2. Attach waterproof drywall to your framing studs
3. Place your tray in desired location and level.
4. The tray is to be placed flat against the waterproof drywall. Prior to placing the tray, apply silicone to the back side of the tray tile flange (the side being placed flat against the waterproof drywall)
5. Secure the tray's add-on tile flange to the waterproof drywall with screws.
6. Apply tile adhesive onto the waterproof drywall and tile flange.
7. Place tile onto the tile adhesive. The tile will go down to the tray's tile flange and final tiles will rest on the edge of the tile flange.
8. After tile is fully set, apply another layer of silicone caulking on the entire perimeter of the tile.

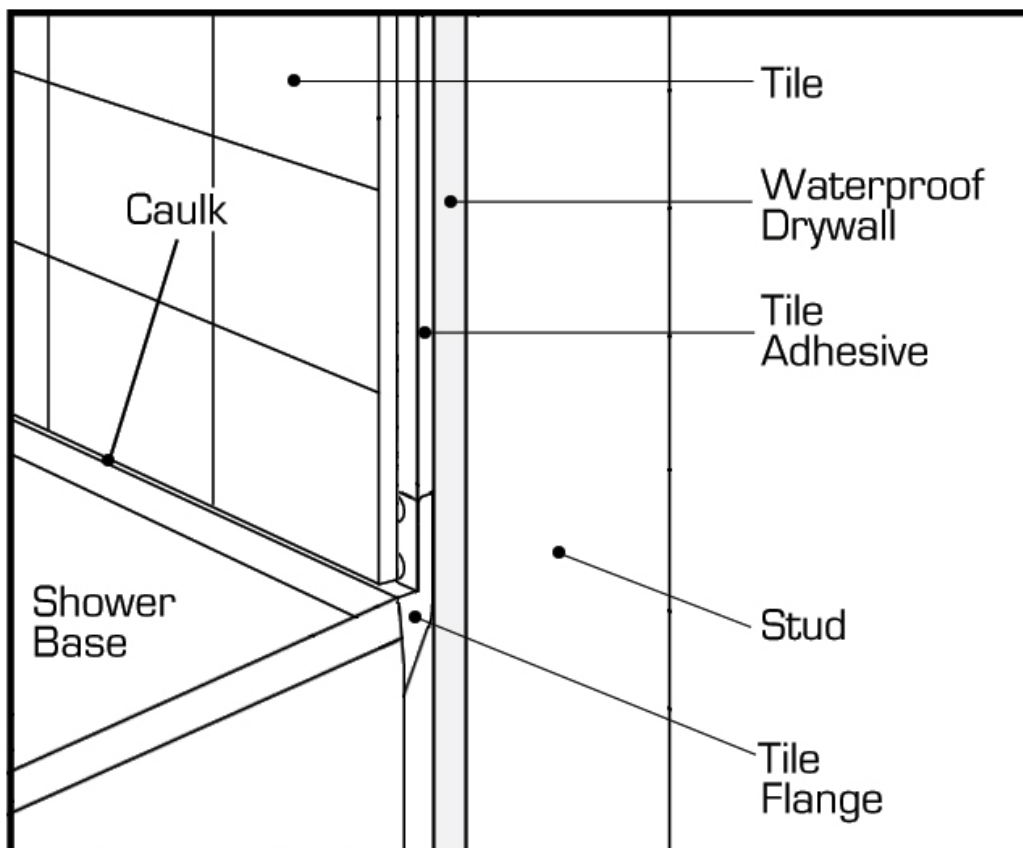

DreamLine

Shower Enclosure, Jetted Shower and Shower Columns

Limited Warranty

CONSUMER RESPONSIBILITIES

Your DreamLine Shower Products will remain beautiful for many years if you take care of them. Some of the waterproofing plastic strips and other seals will need to be replaced when they show signs of wear, yellowing, or are not watertight. Refer to the parts list of your manual for all seals. Water conditions in various parts of the country will determine any extra cleaning attention you may have to give your new shower enclosure or jetted shower. DreamLine does not recommend the use of harsh abrasive cleansers on any of its products. Harsh cleansers will damage the metal or glass finish on your shower enclosure or jetted shower.

REQUESTING SERVICE

Here's what you need to do if you require service:

1. Contact the dealer or contractor who sold and installed the product. They should be able to solve any problems you may have.
2. If your dealer or contractor cannot solve the problem, they will contact or supply you with the name of the local DreamLine Distributor or a DreamLine Direct Technical Specialist
3. If you are unable to obtain warranty service through either your contractor or DreamLine distributor, please write us directly at

DreamLine
2840 Pine Road, Bld D
Huntingdon Valley, PA 19006
ATTN: Customer Service Department,

4. Include all pertinent information regarding your claim, including a complete description of the product, model numbers, colors, finishes, and the date the product was installed. Include a description of the problem, and a photocopy of your invoice and purchase receipt(s) for the products involved. Also please provide information the name and contact telephone numbers of the contractor and distributor.

Please note that under any circumstances, DreamLine products should not be returned to your dealer, distributor or directly to DreamLine without a written Return Merchandise Authorization (RMA).

LIMITED ONE-YEAR WARRANTY

This warrantee extends only to the original owner/end-user for personal household use only. For commercial uses, additional limitations may apply.

DreamLine warrants acrylic surface against blistering or cracking and chipping resulting from defect in the acrylic surface material when used under normal condition and service for a period of one (1) year from the purchase date.

DreamLine warrants mirrors, shower doors, shower massage systems, faucet finishes and fittings to be free from defects in workmanship and materials under normal use and service for a period of one (1) year.

DreamLine further warrants the structure of the acrylic shell against loss of water through the fiberglass laminate of the acrylic body as a result of defect in materials and workmanship for a period of five (5) years from the purchase date.

DreamLine will, at its election, repair, replace, or make appropriate adjustment where DreamLine optional inspection discloses any such defects occurring in normal usage within the warrantee periods. **Please note that DreamLine is not responsible for installation or removal costs.**

Improper modification of any enclosure, jetted shower or shower column components may void the warranty - so please install the product as directed in the manual. This warranty does not cover any claim arising from abuse, misuse, negligence, accident, improper installation or operations on the part of the purchaser. This warranty is void if the DreamLine product is subject to alterations, or if repairs are attempted by anyone other than an authorized agent of DreamLine. This warranty does not extend to any plumbing or components installed by dealers, installers or by any party other than DreamLine.

Implied warranties, including that of merchantability or fitness for a particular purpose, are expressly limited in duration to the duration of this warranty. DreamLine disclaims any liability for special, incidental, or consequential damages.

Some states do not allow limitations on how long an implied warranty lasts or the exclusion or limitation of special, incidental, or consequential damages, so these limitations and exclusions may not apply to you. This warranty gives you specific legal rights. You may also have other rights which vary from state to state. This limited warranty provides specific legal rights as they apply within the USA, and other rights may be available, but may vary from country to country.

This is our exclusive written warranty for DreamLine Enclosure, Jetted Shower and shower Column Purchases made after May 2004. DreamLine reserves the right to modify this warranty at any time, and the consumer understands that such modification will not alter the warranty conditions applicable at the time of the sale of the product.