



Riviera / DLG-51

Complete Shower Room User's Guide



I. Mounting Preparation

1. After opening the case, read this introduction carefully, check all the packed parts, examine the shower cabinet for shipping damage. If the unit has been damaged or has a finishing defect, please contact your local distributor within 2 business days. Please note that DreamLine Guarantee will not cover shipping damage or such finishing defects once the unit has been installed. Your distributor's responsibility for damage in transit is limited after the shower package has been transferred to the transportation company, so you may have to contact the transportation company directly to report damage. Contact your distributor or DreamLine if you have any questions.
2. You should make sure that the floor is leveled and solid and will be able to support the total weight of the unit and its occupant. You should also consult your local building codes on questions on installation compliance standards.
3. Install all of the required plumbing and drainage before securing the shower. Use a competent and licensed (if required by local code) plumber for all plumbing installation.
4. Please insure that prior to the installation the floor is leveled and the walls are at right angles. While some adjustment in leveling of the tray is possible, irregular floor level or improper angle of side walls will result in serious problems for your installation.
5. Necessary Tools: Conventional woodworking tools, Screwdriver, Silicone sealant, Electric drill, Regular drill bits (1/8", 7/64"), Phillips screwdriver, Level, Measuring tape, Pencil and Stepladder. Bear in mind that you will need at least two people to assemble the unit.

II. Packing List

- | | |
|---|--|
| ① Top cover (1 pc) | ⑨ Entry door (2 pcs) |
| ② Jetted panel (1 pc) | ⑩ Stationary side glass panels (2 pcs) |
| ③ M4×16 screws (25 pcs) | ⑪ Wall connecting profiles (2 pcs) |
| ④ M5×20 screws (7 pcs) | ⑫ M4×40 screws (8 pcs) |
| ⑤ M4×14 screws and fixing blocks (8 pcs respectively) | ⑬ M4×14 screws (25 pcs) |
| ⑥ Shower tray (1 pc) | ⑭ Glass block (12 pcs) |
| ⑦ Glass enclosure assembly (1 pc) | ⑮ Guide rail (2 pcs) |
| ⑧ Handles (2 pairs) | |

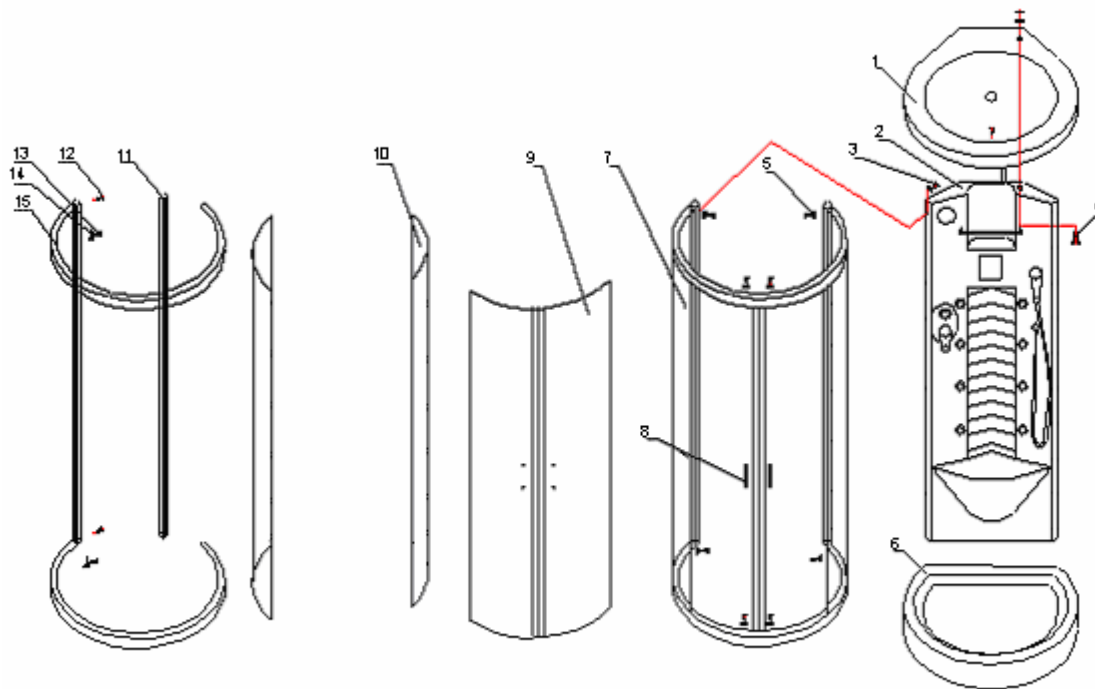

III. Installation Process

1. Place the shower tray in the designated position and level it. If the surface is uneven, level the legs and then fasten the safety nuts.
2. Clean the surface with alcohol before applying silicone to the edges to be connected. Secure the main jetted panel to the tray with bolts and nuts using washers in between.
3. Attach the wall connecting profiles to the edges of the main jetted panel. Do not forget to clean the surfaces to be connected and apply a layer of silicone to the edges.
4. Clean the surface of the tray and the surface of the guide rail. Apply a layer of silicone and connect the guide rail with the wall connecting profile using screws. Make sure the screws go into the designated threaded holes in the guide rails.
5. Attach the flexible waterproof plastic strip onto the stationary side glass. For easier insertion of the glass into the wall connecting profile you may use liquid soap on the strip.
6. Insert the glass panel into the guide rail and the wall connecting profile.
7. Repeat the same step with the other stationary side glass panel.
8. Place the top guide rail onto the glass and fasten the screws. Make sure the screws go into the threaded holes in the guide rail.
9. Insert the doors through the grooves in the guide rails. Loosen the eccentrics on the rollers if the doors are going tight into the guide rails.
10. Adjust the door rollers making sure the doors slide smoothly and close tight. Attach the waterproof plastic strips to the stationary side glass panels.
11. Attach the handles.
12. Place the roof top onto the shower cabin to complete the assembly of the shower cabin.
13. Connect wire to the lamp and connect hot and cold water pipes to the water supply.

IV. Sealing:

Apply clear silicone water sealant around the outside perimeter of any fixed shower components (horizontally between bottom of any fixed side glass panels and tray, as well as vertically between the wall, wall profiles and any side glass panels). Do not apply silicone on the inside of the shower – this will cause your shower unit to leak.

NOTE: Allow 24 hours for the silicone to set before testing or using the shower.

NOTE: Improper application of silicone sealant may cause your shower to leak.

DreamLine

Shower Enclosure, Jetted Shower and Shower Columns

Limited Warranty

CONSUMER RESPONSIBILITIES

Your DreamLine Shower Products will remain beautiful for many years if you take care of them. Some of the waterproofing plastic strips and other seals will need to be replaced when they show signs of wear, yellowing, or are not watertight. Refer to the parts list of your manual for all seals. Water conditions in various parts of the country will determine any extra cleaning attention you may have to give your new shower enclosure or jetted shower. DreamLine does not recommend the use of harsh abrasive cleansers on any of its products. Harsh cleansers will damage the metal or glass finish on your shower enclosure or jetted shower.

REQUESTING SERVICE

Here's what you need to do if you require service:

1. Contact the dealer or contractor who sold and installed the product. They should be able to solve any problems you may have.
2. If your dealer or contractor cannot solve the problem, they will contact or supply you with the name of the local DreamLine Distributor or a DreamLine Direct Technical Specialist
3. If you are unable to obtain warranty service through either your contractor or DreamLine distributor, please write us directly at

DreamLine
2840 Pine Road, Bld D
Huntingdon Valley, PA 19006
ATTN: Customer Service Department,

4. Include all pertinent information regarding your claim, including a complete description of the product, model numbers, colors, finishes, and the date the product was installed. Include a description of the problem, and a photocopy of your invoice and purchase receipt(s) for the products involved. Also please provide information the name and contact telephone numbers of the contractor and distributor.

Please note that under any circumstances, DreamLine products should not be returned to your dealer, distributor or directly to DreamLine without a written Return Merchandise Authorization (RMA).

LIMITED ONE-YEAR WARRANTY

This warrantee extends only to the original owner/end-user for personal household use only. For commercial uses, additional limitations may apply.

DreamLine warrants acrylic surface against blistering or cracking and chipping resulting from defect in the acrylic surface material when used under normal condition and service for a period of one (1) year from the purchase date.

DreamLine warrants mirrors, shower doors, shower massage systems, faucet finishes and fittings to be free from defects in workmanship and materials under normal use and service for a period of one (1) year.

DreamLine further warrants the structure of the acrylic shell against loss of water through the fiberglass laminate of the acrylic body as a result of defect in materials and workmanship for a period of five (5) years from the purchase date.

DreamLine will, at its election, repair, replace, or make appropriate adjustment where DreamLine optional inspection discloses any such defects occurring in normal usage within the warrantee periods. **Please note that DreamLine is not responsible for installation or removal costs.**

Improper modification of any enclosure, jetted shower or shower column components may void the warranty - so please install the product as directed in the manual. This warranty does not cover any claim arising from abuse, misuse, negligence, accident, improper installation or operations on the part of the purchaser. This warranty is void if the DreamLine product is subject to alterations, or if repairs are attempted by anyone other than an authorized agent of DreamLine. This warranty does not extend to any plumbing or components installed by dealers, installers or by any party other than DreamLine.

Implied warranties, including that of merchantability or fitness for a particular purpose, are expressly limited in duration to the duration of this warranty. DreamLine disclaims any liability for special, incidental, or consequential damages.

Some states do not allow limitations on how long an implied warranty lasts or the exclusion or limitation of special, incidental, or consequential damages, so these limitations and exclusions may not apply to you. This warranty gives you specific legal rights. You may also have other rights which vary from state to state. This limited warranty provides specific legal rights as they apply within the USA, and other rights may be available, but may vary from country to country.

This is our exclusive written warranty for DreamLine Enclosure, Jetted Shower and shower Column Purchases made after May 2004. DreamLine reserves the right to modify this warranty at any time, and the consumer understands that such modification will not alter the warranty conditions applicable at the time of the sale of the product.