

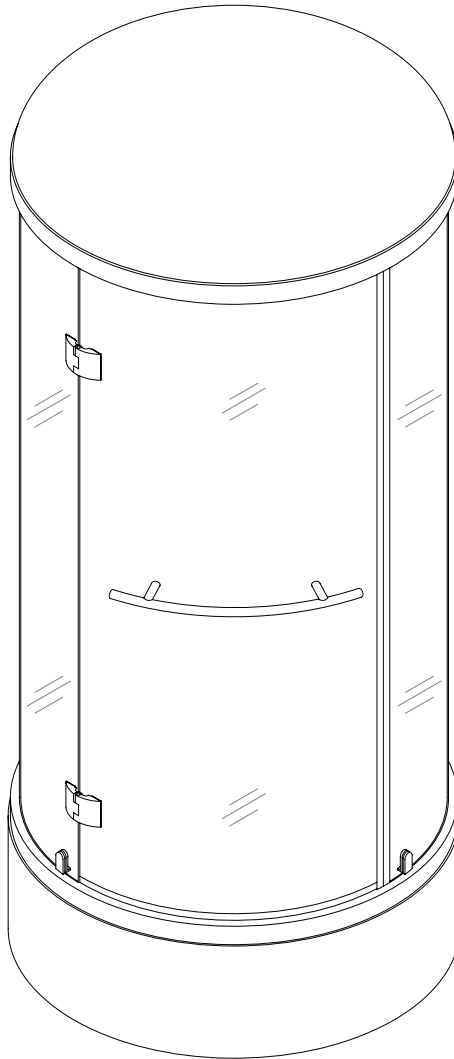

Murano Shower Cabin Installation Instruction

IMPORTANT

Please read carefully the following instructions before installing your shower cabin. If you have any questions on this shower cabin installation - please call our technical support specialists Monday to Friday 9:00AM – 5:00PM EST at 1-866-731-8378 Option 3 or e-mail our technical support group at support@BathAuthority.com



Our product may have changes without prior notice

Preparation

1. After opening all the boxes, read this introduction carefully, check all the packed parts are complete by cross checking all the components against the “Detailed Diagram of Shower Cabin Components”. Examine for shipping damage. If the unit has been damaged or has a finishing defect, please contact your local distributor within 3 business days. Please note that **Bath Authority™ / DreamLine™ will not replace any damaged product or parts free of charge after 3 business days or if the product has been installed.** Contact your distributor if you have any questions.
2. **Please note that you should consult your local building codes on questions on installation compliance standards. Building and plumbing codes vary by location, and DreamLine is not responsible for code compliance standards for your project.**
3. Install all of the required plumbing and drainage before securing the shower. **Use a competent and licensed (if required by local code) plumber for all plumbing installation.**
4. Please insure that prior to the installation the floor is leveled and solid and will be able to support the total weight of the unit and its occupant. Also make sure the walls are at right angles. While some adjustment in leveling of the tray is possible, irregular floor level or improper angle of side walls will result in serious problems for your installation. Please, note that there are some adjustments and drilling might be necessary during the installation process.

Tools Required

Electric drill, Pencil, Phillips screwdriver, Slotted screwdriver, 3/8 Wrench, 3/8 Socket, Tape measure, Spirit level with horizontal and vertical indicators, silicon caulk.

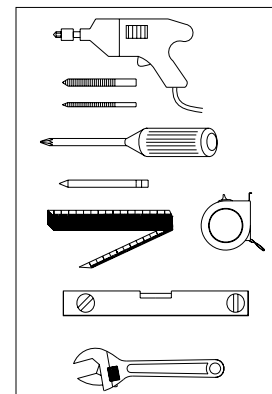

Detailed Diagram of Shower Cabin Components

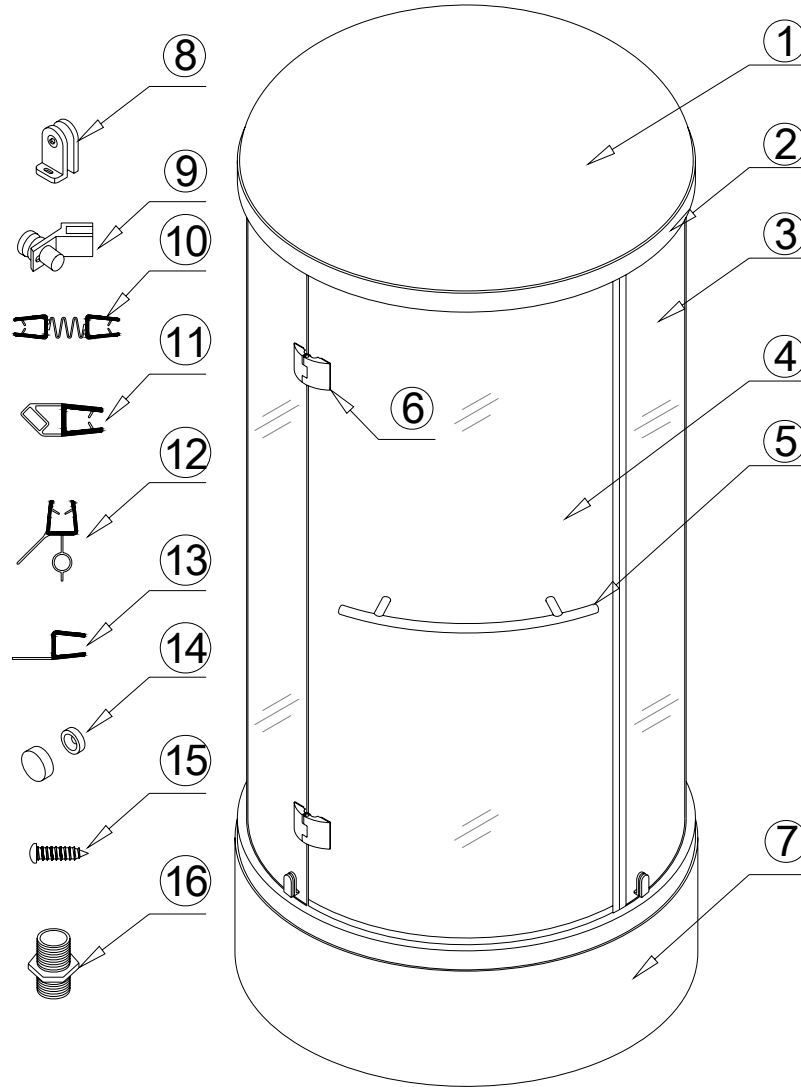

Packing List

01	Roof cover panel	1 pc	12	Glass door bottom strip	1 pc
02	Roof	1 pc	13	Stationary glass anti-water strip	2 pcs
03	Stationary glass panel	3 pcs	14	Decorative cover	12 sets
04	Glass door	1 pc	15	Round head screw ST4.2×16	12 pcs
05	Handle	1 pc	16	1/2" Brass Nipple	2 pcs
06	Hinge	2 pcs	17	1/2" Nipple with chrome cover	2 pcs
07	Bottom tray	1 pc	18	Jetted panel	1 pc
08	Glass bracket	12 pcs	19	Glass shelf	1 pc
09	Jetted panel lock	1 set	20	Hand shower set	1 pc
10	Connected anti-water strip	1 pc	21	Water supply hose long	2 pcs
11	Magnetic strip	2 pcs	22	Water supply hose short	2 pcs

Cabin Installation

1. Choose a place where you want to install the shower cabin.
2. Refer to Diag. 1 and Fig. 1 for the drain position. Make sure the position of the floor holes for drain and wall outlets for hot and cold water pipes (if you have the water supply from under the floor) will be not under the leg frame or tray drain. The cold and hot water supply pipes should have ½" female connectors (shown in the picture), and the connector should be on the level with the floor. It will make it easier to move the shower cabin to the final place (fig 1).
3. Remove 4 screws from the tray front skirt and then gently remove the skirt itself. Start from the right side and slowly pull it out. It may be easier to put the tray aside and push the skirt from inside out.
4. Place the tray without the skirt to the installation area and level it using adjustable legs. Be sure, all legs are standing on the floor and supporting tray. Tighten all legs with nuts so they will not move.
5. Pull the **tray (7)** from the installation area to assemble area.
6. Install two **1/2" Nipples with chrome cover (17)** for hot and cold water on the top of the tray in the pre-drilled holes (refer to fig 7: top right image).
7. Take out the **three stationary glass panels (3)** then attach the **glass brackets (8)**. Please notice that the three stationary glass panels are different from each other, they should be placed in the right sequence (fig 2).
8. Attach the back stationary glass panel to the tray using **Round head screw ST4.2x16 (15)**, then cover the screws with the **decorative covers (14)** (fig 3).
9. Push the **stationary glass anti-water strip (13)** to the back stationary glass panel then attach the two glass side panels to the tray (fig 4).
10. Place the **roof (2)** on top of the fixed glass panels then adjust it to the required position (the hole for the head shower hose should be towards to back). Attach the roof to the stationary glass panels using **Round head screw ST4.2x16 (15)**, then cover the screws with the **decorative covers (14)** (fig 5).
11. Attach the **jetted glass panel (18)** to the back glass panel (fig 6).
12. Connect the hot and cold water hoses, then the top shower tubing (fig7).
13. Install the **Jetted panel lock (9)** (fig 8).
14. Hang the **glass shelf (19)** (fig 9).
15. Connect the **hand-held shower (20)**.
16. Attach the **hinges (6)** to the glass door and then hang the door to the stationary glass panel (fig 10).
17. Install the door **handle (5)** (fig 11, 12).
18. Attach the **connected anti-water strip (10)** between hinged side of the glass door and left stationary glass; **magnetic strips (11)** on the other side of the glass door and the right stationary glass; the **glass door bottom strip (12)** (fig 13).
19. Put the **roof cover panel (1)** on a top of the roof (fig 14).
20. Remove the access panel on the back of the tray. Move the shower cabin to the required position then connect the flex outlet water pipe to the drain pipe (fig 15). You can use 1 1/2" or 2" PVC pipes with 1 1/2" female threaded adapter to connect the drain pipe to the drain assembly on the tray.
21. If you use water supply lines from the floor then tighten supplied 1/2" brass nipples to the water lines (use Teflon tape for water-tight connection) (fig 16). Then connect the hot and cold water outlets to the nipples on the tray using supplied **short hoses (22)** (fig 17).
22. If you use water supply lines from the wall then you will need to provide water connection to the cabin.
23. Open the water supply valves to see if there is any water leakage under the tray. In case no leakage is found, close the access panel.
24. Apply clear silicon inside of the cabin between the stationary glass panels and the tray. Let it dry for 24 hours.

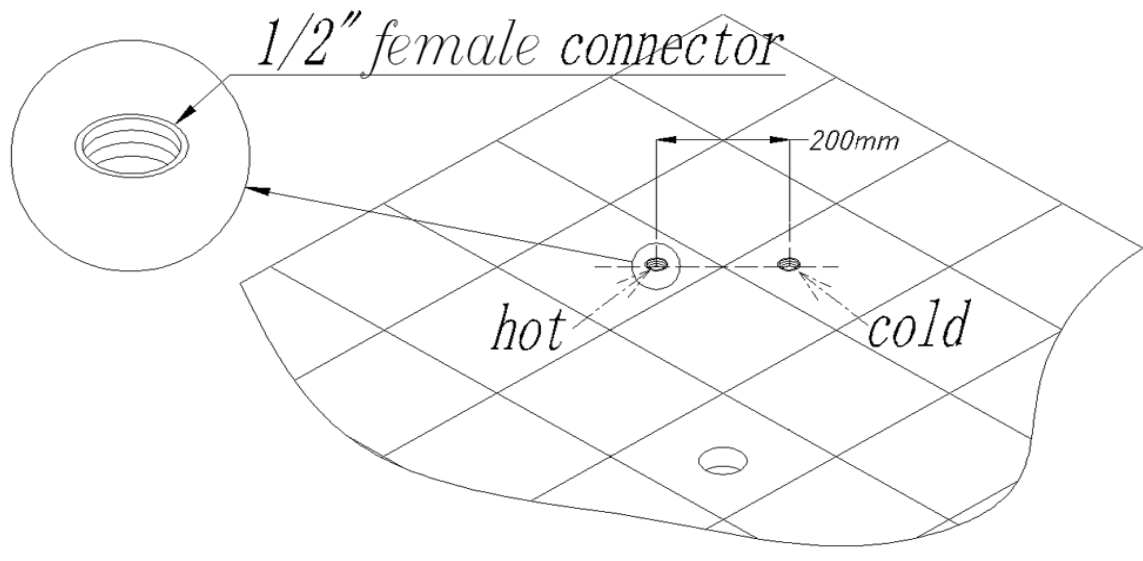
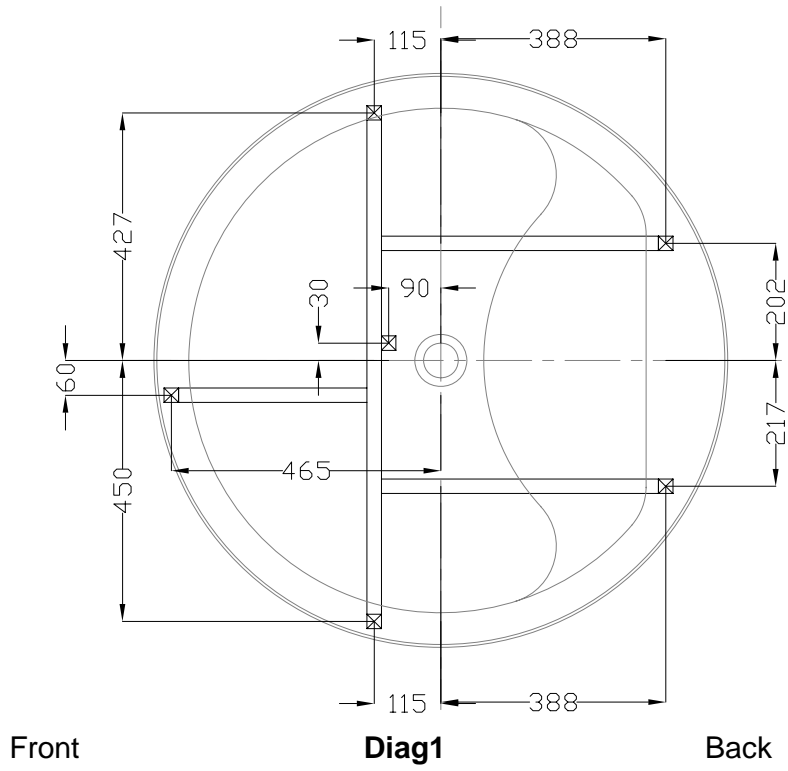

Fig 1

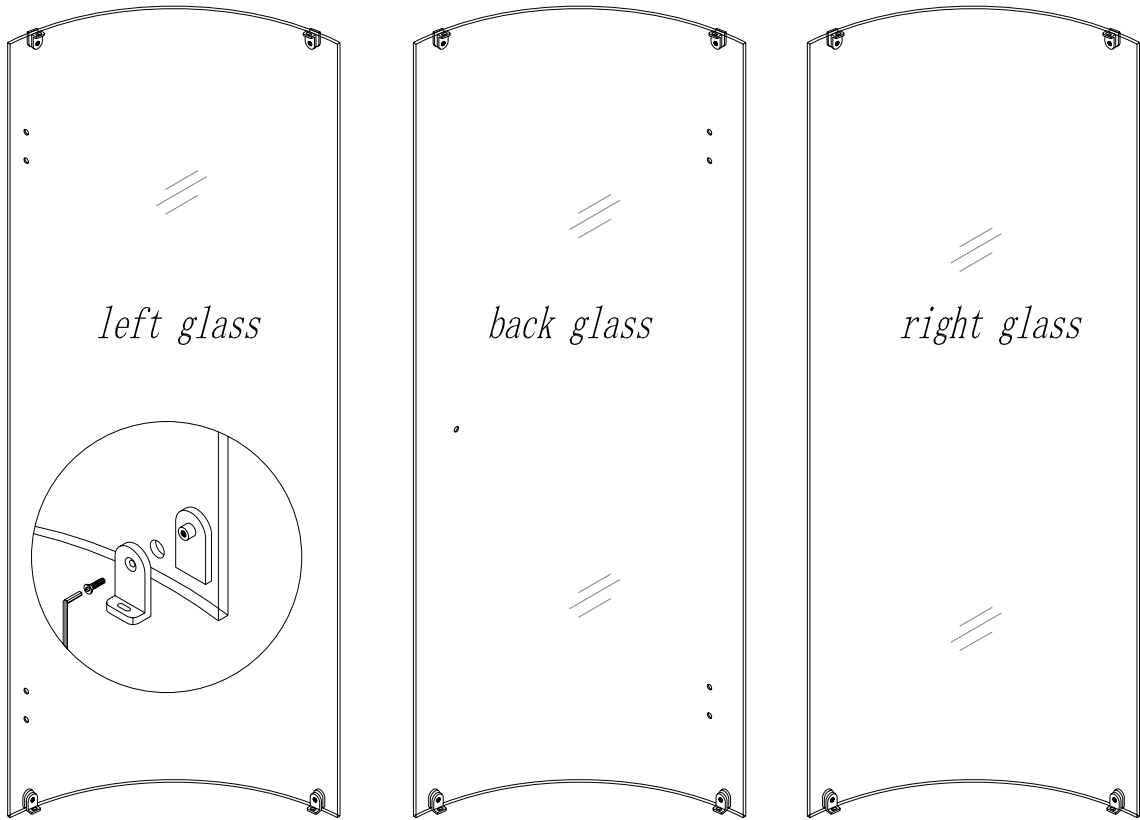

Fig 2

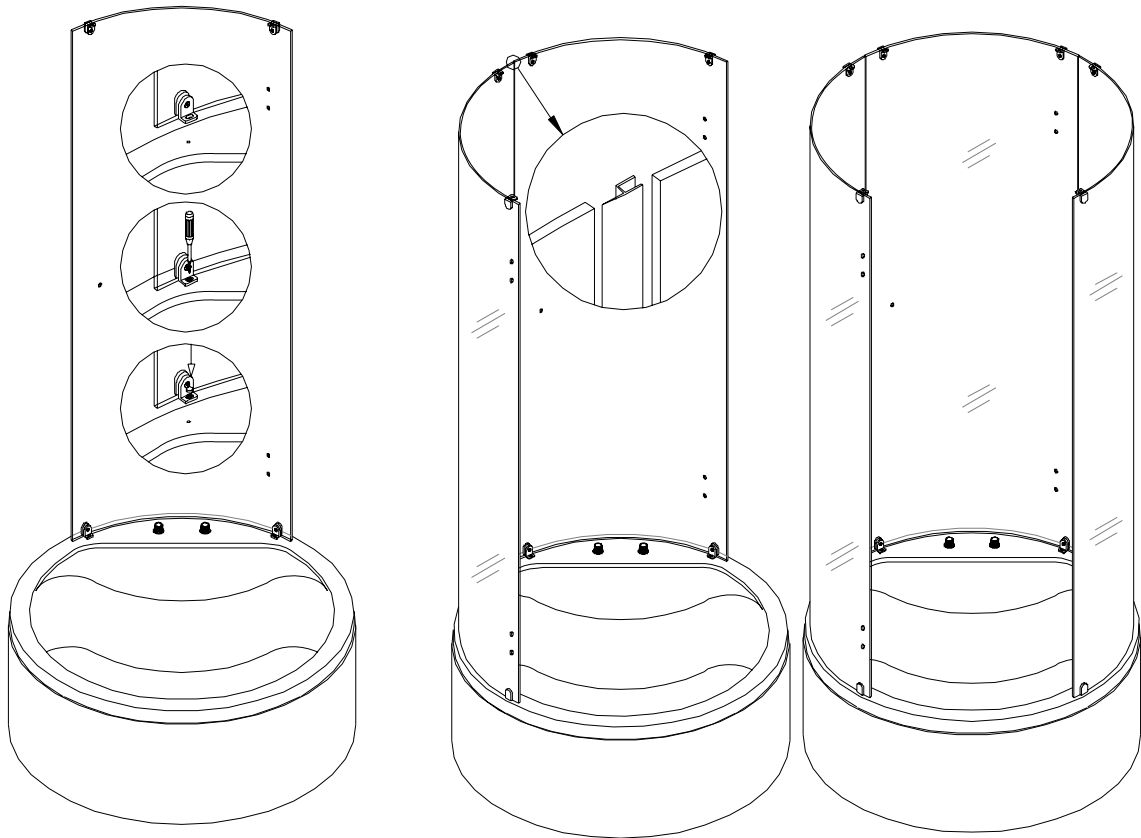

Fig 3

Fig 4

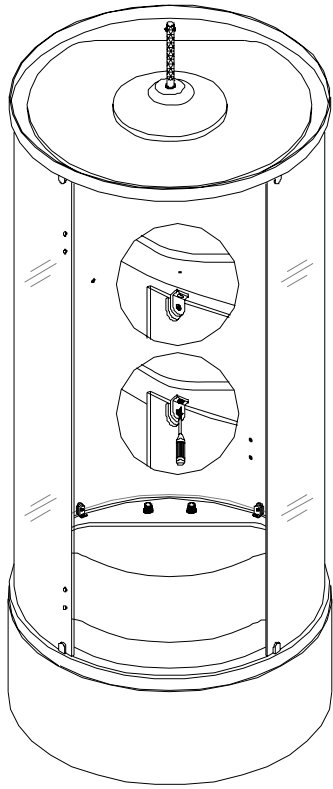

Fig 5

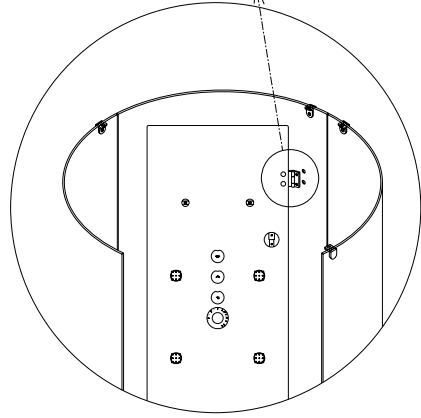
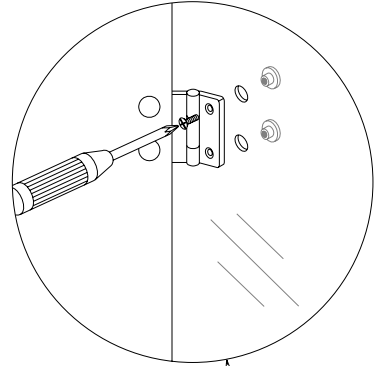
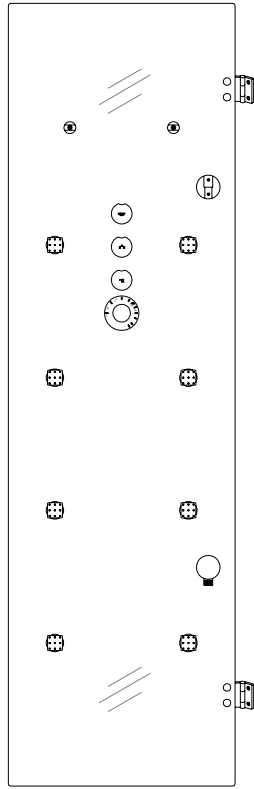

Fig 6

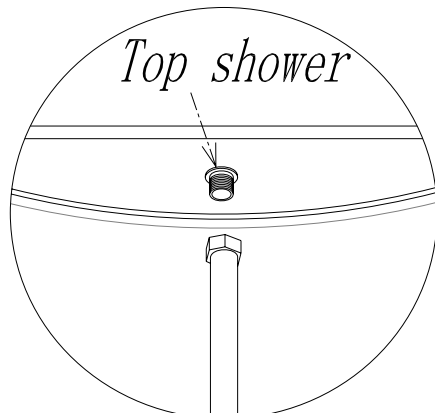
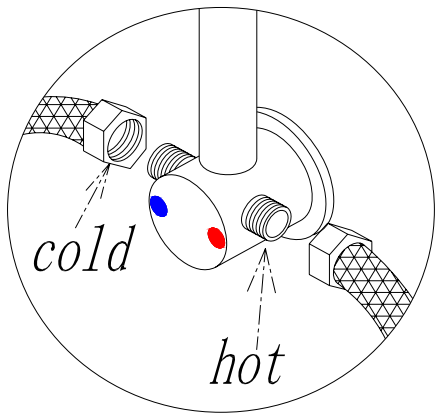
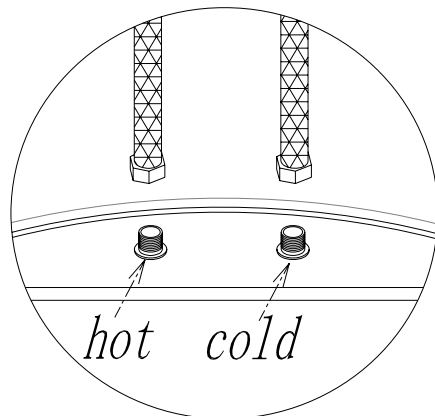
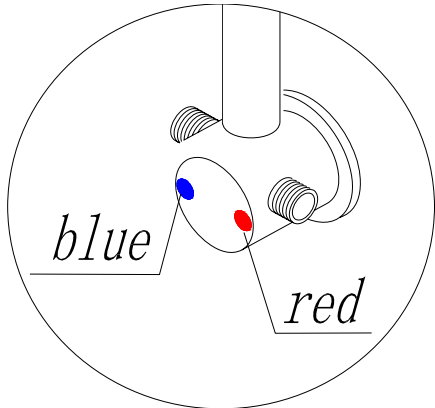

Fig 7

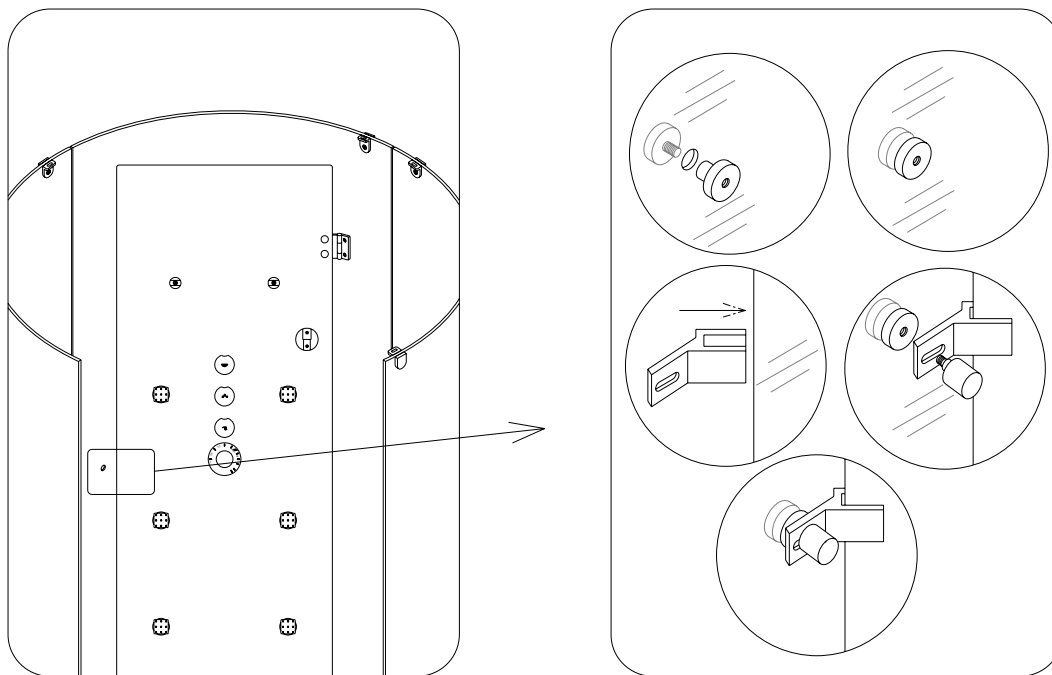

Fig 8

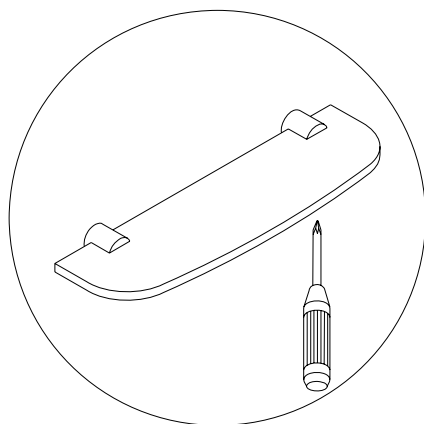
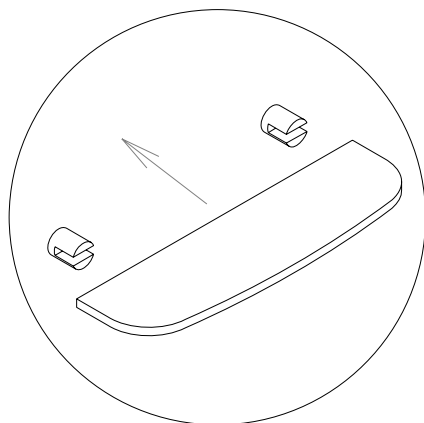

Fig 9

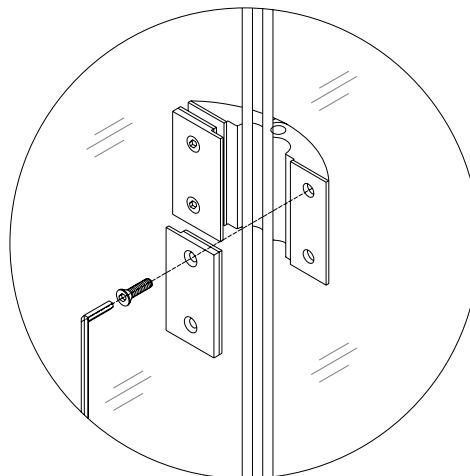
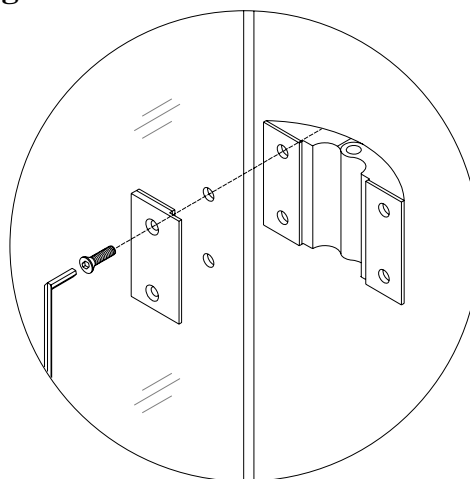

Fig 10

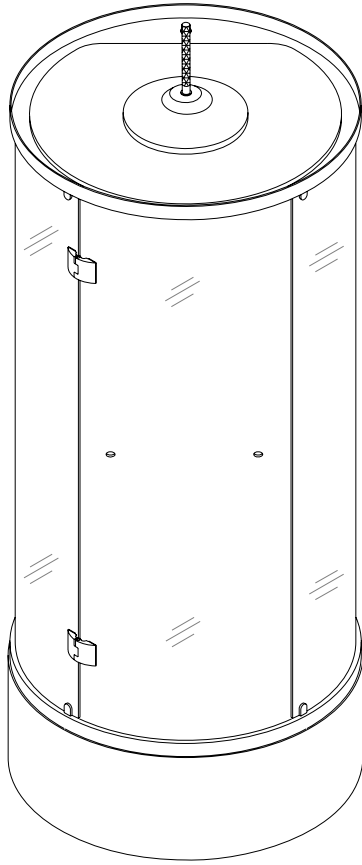

Fig 11

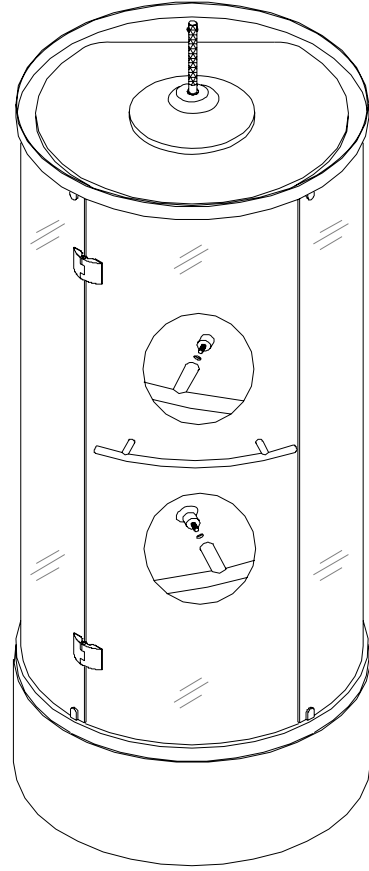

Fig 12

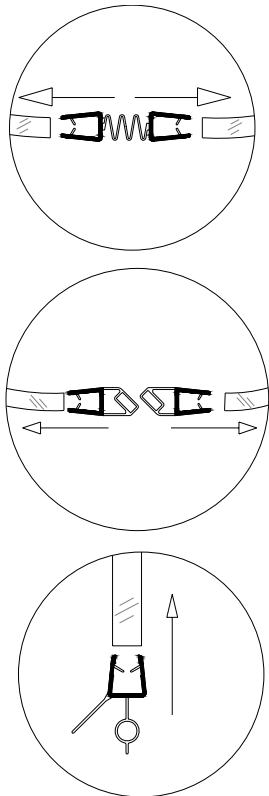

Fig 13

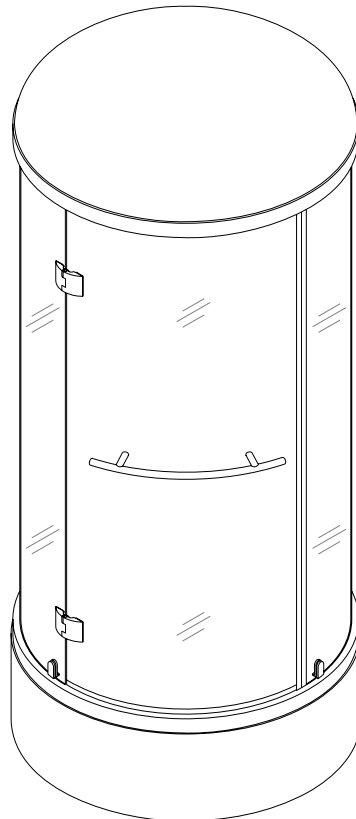

Fig 14

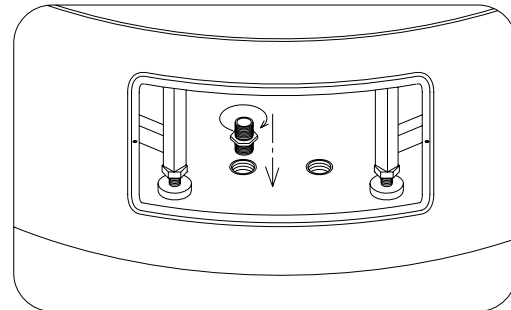
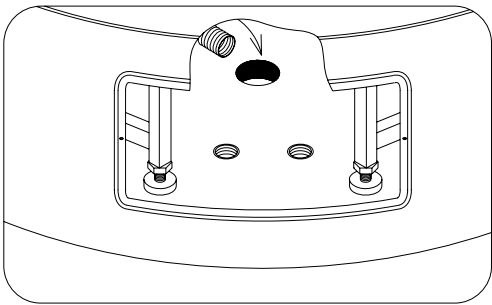
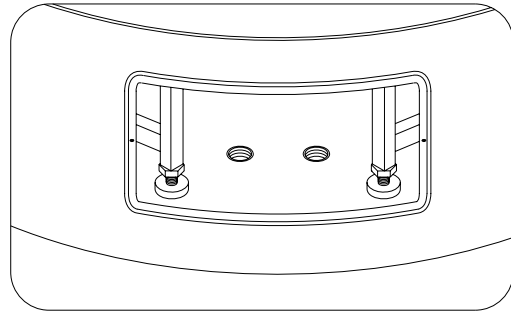
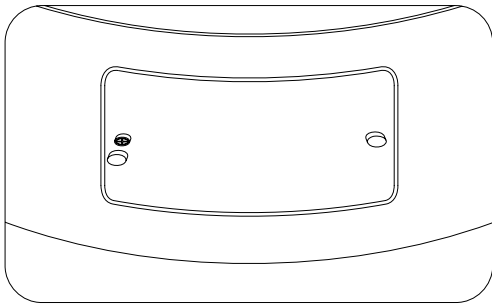

Fig 15

Fig 16

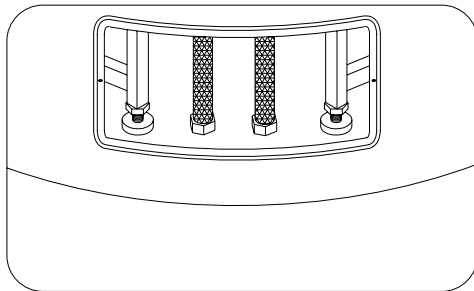
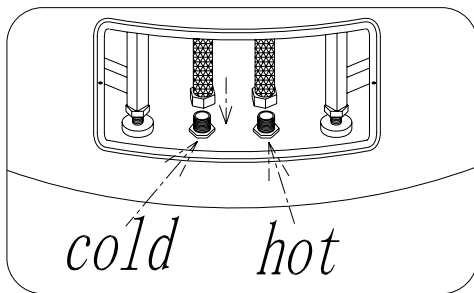

Fig 17

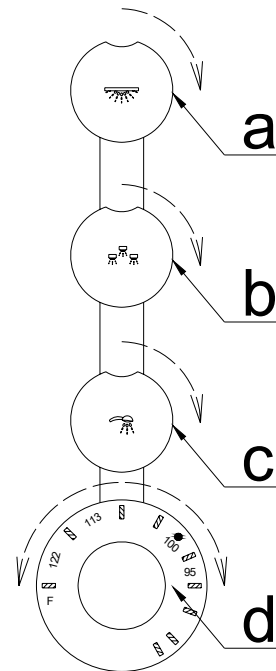

Fig 18

Using controls

- Valve “a” turns on water of the “tropical rain” head shower.
- Valve “b” turns on water of massage jets.
- Valve “c” turns on water of the hand shower. Turn the revolve cover of the shower head will change water pattern.
- Thermostatic valve “d” adjusts water temperature on any valves you are using.

Product maintenance

Acrylic cleaning. Acrylic should be cleaned with warm water and a clean, nonabrasive cloth. If desired, a mild, nonabrasive detergent may also be used. Use only light pressure when cleaning. Avoid rubbing dirt or grit into the surface. Turn the cloth often and replace with a clean cloth frequently. Dry by blotting gently with a clean, dry cloth.

DO NOT USE window cleaning sprays, alcohol, kitchen abrasive compounds, or solvents (such as acetone, gasoline, or thinners). Do not use ammonia based cleaning solutions on the acrylic as it will eat into the surface and cause it to damage.

How do you get scratches out of Acrylic? For light scratches, use a buffing compound such as car wax, using the buffer provided slightly buff the surface by hands until scratches disappear.

Glass cleaning. Use any normal household glass cleaning product such as Windex to clean your glass. Be **careful of overspray and wipe off any that gets on the frame.**

Aluminum maintenance. Use mild cleaning agent dipped soft cloth mop off all dirty and dust on glass. Do not use abrasive cleaning agent or polishing wax, alcohol, acetone etc.

Bath Authority™ LLC / DreamLine™

Shower Enclosure, Jetted/Steam Shower and Shower Columns

Limited Warranty

CONSUMER RESPONSIBILITIES

Your DreamLine™ Shower Products will remain beautiful for many years if you take care of them. Some of the waterproofing plastic strips and other seals will need to be replaced when they show signs of wear, yellowing, or are not watertight. Refer to the parts list of your manual for all seals. Water conditions in various parts of the country will determine any extra cleaning attention you may have to give your new shower enclosure or jetted shower. DreamLine™ does not recommend the use of harsh abrasive cleansers on any of its products. Harsh cleansers will damage the metal or glass finish on your shower enclosure or jetted shower.

REQUESTING SERVICE

Here's what you need to do if you require service:

1. Contact the dealer who sold and/or installed the product. They should be able to solve any problems you may have.
2. If your dealer or contractor cannot solve the problem, they will contact or supply you with the name of the local DreamLine™ Distributor or a DreamLine™ Direct Technical Specialist
3. If you are unable to obtain warranty service through either your contractor or DreamLine™ distributor, please write us directly at

Bath Authority™ LLC / DreamLine™
909 Louis Drive
Warminster, PA 18974
ATTN: Customer Service Department

4. Include all pertinent information regarding your claim, including a complete description of the product, model numbers, colors, finishes, and the date the product was installed. Include a description of the problem and a photocopy of your invoice and purchase receipt(s) for the products involved. Also please provide information on the name and contact telephone numbers of the contractor and distributor.

Please note that under any circumstances, DreamLine™ products should not be returned to your dealer, distributor or directly to DreamLine™ without a written Return Merchandise Authorization (RMA).

LIMITED ONE-YEAR WARRANTY

This warrantee extends only to the original owner/end-user for personal household use only. For commercial uses, additional limitations may apply.

DreamLine™ warrants acrylic surface against blistering or cracking and chipping resulting from defect in the acrylic surface material when used under normal condition and service for a period of one (1) year from the purchase date.

DreamLine™ warrants mirrors, shower doors, shower massage systems, faucet finishes and fittings to be free from defects in workmanship and materials under normal use and service for a period of one (1) year.

DreamLine™ further warrants the structure of the acrylic shell against loss of water through the fiberglass laminate of the acrylic body as a result of defect in materials and workmanship for a period of five (5) years from the purchase date.

DreamLine™ will, at its election, repair, replace, or make appropriate credit adjustment where DreamLine™ optional inspection discloses any such defects occurring in normal usage within the warrantee periods.

Please note that DreamLine™ is not responsible for any installation or removal costs.

Improper modification of any enclosure, jetted shower or shower column components may void the warrantee - so please install the product as directed in the manual. This warrantee does not cover any claim arising from abuse, misuse, negligence, accident, improper installation or operations on the part of the purchaser. This warrantee is void if the DreamLine™ product is subject to alterations, or if repairs are attempted by anyone other than an authorized agent of DreamLine™. This warrantee does not extend to any plumbing or components installed by dealers, installers or by any party other than DreamLine™.

Implied warranties, including that of merchantability or fitness for a particular purpose, are expressly limited in duration to the duration of this warranty. DreamLine™ disclaims any liability for special, incidental, or consequential damages.

Some states do not allow limitations on how long an implied warranty lasts or the exclusion or limitation of special, incidental, or consequential damages, so these limitations and exclusions may not apply to you. This warranty gives you specific legal rights. You may also have other rights which vary from state to state. This limited warranty provides specific legal rights as they apply within the USA, and other rights may be available, but may vary from country to country.

This is our exclusive written warranty for DreamLine™ Shower Enclosure, Jetted/Steam Shower and Shower Column purchases made after May 2004. DreamLine™ reserves the right to modify this warranty at any time, and the consumer understands that such modification will not alter the warranty conditions applicable at the time of the sale of the product.